

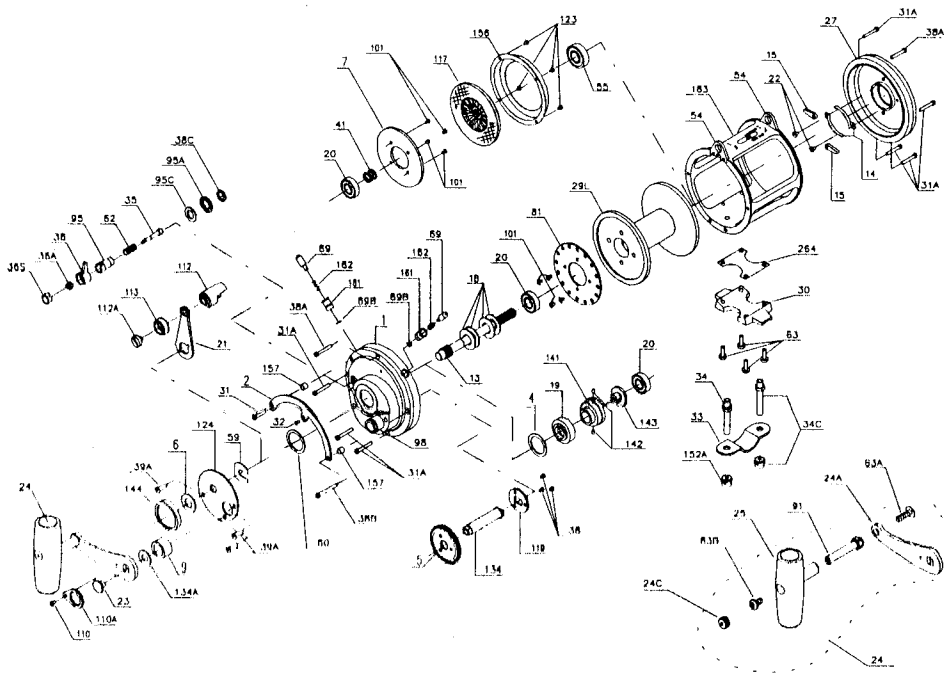

PARTS AND PRICE LIST FOR 30T AND 30TW



| Key No. | Part No. | Description | Price | Key No. | Part No. | Description | Price |
|---------|-------------|----------------------------------|---------|---------|-----------|----------------------------------|--------|
| 1 | 001 030TN | Right Side Plate Assembly | \$80.00 | 39A | 039A080S | Cover Screw (3 req.) | \$.45 |
| 2 | 002 030 | Quadrant Ring | 5.65 | 41 | 041 050 | L.S. Bearing Spring | .90 |
| 4 | 004 030 | Cam Thrust Washer | .95 | 54 | 054 030T | Harness Lug (2 req.) | 2.45 |
| 5 | 005 050 | Main Gear (30T) | 12.30 | 55 | 055 080 | L.S. Bearing | 16.00 |
| | 005 050W | Main Gear (30TW) | 12.30 | 59 | 059 050 | Slotted Washer | .80 |
| 6 | 006 155 | Spacer Washer | .60 | 60 | 060 050 | Backing Washer | .90 |
| 7 | 007 030 | Metal Drag Washer | 7.75 | 62 | 062 050 | Click Spring | .80 |
| 9 | 009 030 | Spacer Sleeve | .70 | 63 | 063 030T | Stand Screws (4 req.) | .80 |
| 13 | 013 030 | Pinion Gear | 22.00 | 63A | 063 050 | Screw | .75 |
| | 013 030TW | Pinion Gear | 25.00 | 63B | 063A050 | Long Screw | 1.25 |
| 14 | 014 050 | Dog Spring (2 req.) | 1.00 | 69 | 069 050 | Locating Pin (2 req.) | 1.20 |
| 15 | 015 050 | Dog (2 req.) | .80 | 69B | 069B050 | Retaining Ring (2 req.) | .80 |
| 18 | 018 030 | Disc Clutch Spring (4 req.-30T) | .85 | 81 | 081 050 | Ratchet | 5.15 |
| | 018 030TW | Disc Clutch Spring (4 req.-30TW) | .85 | 91 | 091N050 | Handle Rivet | 2.50 |
| 19 | 019 030W | Eccentric Cam | 12.50 | 95 | 095 050 | Click Tongue Bushing | 2.05 |
| 20 | 020L704 | Ball Bearing (3 req.) | 14.00 | 95A | 095A020 | Click Bushing Washer | .65 |
| 21 | 021 030 | Eccentric Lever | 5.65 | 95C | 095C050 | Click Bushing Washer | .65 |
| 22 | 022 109 | Dog Spring Screw (2 req.) | .55 | 98 | 098 030TN | Bridge Bushing | 3.80 |
| 23 | 023 114 | Handle Screw | 2.65 | 101 | 101 030 | Drive Plate Screw (8 req.) | .45 |
| 24 | 024 030TW | Handle Complete | 17.00 | 110 | 110 050 | Handle Lock Screw | .50 |
| 24A | 024 030TW-1 | Handle Blank Only | 6.40 | 110A | 110A050 | Handle Locking Plate | 2.40 |
| 24C | 024C050 | Handle Knob Cap | 1.25 | 112 | 112 050 | Eccentric Lever Knob | 16.25 |
| 25 | 025 050 | Handle Knob | 6.00 | 112A | 112A050 | Eccentric Knob Screw | .90 |
| 27 | 027 030T | L.S. Plate Assembly | 60.00 | 113 | 113 050 | Eccentric Lever Cap | 3.95 |
| 29L | 029L030T | Spool | 67.00 | 117 | 117D030 | Drive Plate w/ Drag Washer | 15.00 |
| | 029L030TW | Spool | 73.95 | 119 | 119 050 | Coupling Plate | 1.35 |
| 30 | 030 020T | Stand | 18.70 | 123 | 123 050 | Drag Cover Screw (4 req.) | .45 |
| 31 | 031T020 | Short Quadrant Screw | .55 | 124 | 124 030 | Bridge Cover | 5.90 |
| 31A | 031T080 | Frame Screw (7 req.) | .55 | | 125 030 | Cam Housing | 7.25 |
| 32 | 032 014CH | Center Quadrant Screw | .40 | 134 | 134 050 | Gear Stud | 6.50 |
| 33 | 033 990 | Rod Clamp (30T) | 3.95 | 134A | 134A050 | Gear Stud Washer | .90 |
| | 033 114 | Rod Clamp (30TW) | 5.30 | 141 | 141 030 | Cam Follower | 5.65 |
| | 033R114 | Ringed Rod Clamp (30TW only) | 9.95 | 142 | 142 050 | Cam Follower Pin (2 req.) | .60 |
| 34 | 034 050T | Clamp Screw (Only) | 2.05 | 143 | 143 030 | Adjusting Screw | 4.00 |
| 34C | 034C050T | Rod Clamp Screw w/Nut | 3.40 | 144 | 144 050 | Preset Knob | 6.95 |
| 35 | 035 050N | Click Tongue | 3.10 | 152A | 152A050T | Rod Clamp Acorn Nut (2 req.) | 1.35 |
| 36 | 036 050 | Click Button | 7.00 | 156 | 156 030T | Drag Cover | 5.05 |
| 36A | 036 700 | Click Button Nut | .90 | 157 | 157 050 | Quadrant Spacer Bushing (2 req.) | .60 |
| 36S | 036S080ST | Click Button Cap | .40 | 161 | 161 050 | Locating Pin Bushing (2 req.) | 1.20 |
| 38 | 038 007 | Coupling Plate Screw (3 req.) | .40 | 162 | 162 050 | Locating Pin Spring (2 req.) | .50 |
| 38A | 038T050 | Frame Screw (2 req.) | .50 | 183 | 183 030T | Tube Frame | 90.00 |
| 38B | 038T080 | Long Quadrant Screw | .55 | | 183 030TW | Tube Frame | 95.00 |
| 38C | 038 710 | Click Bushing Nut | .50 | 264 | 264 030T | Stand Gasket | 1.60 |
| Note: | 3-30 Bridge | Use For OLD STYLE R.S. Plate | 14.30 | | | | |